

ACT

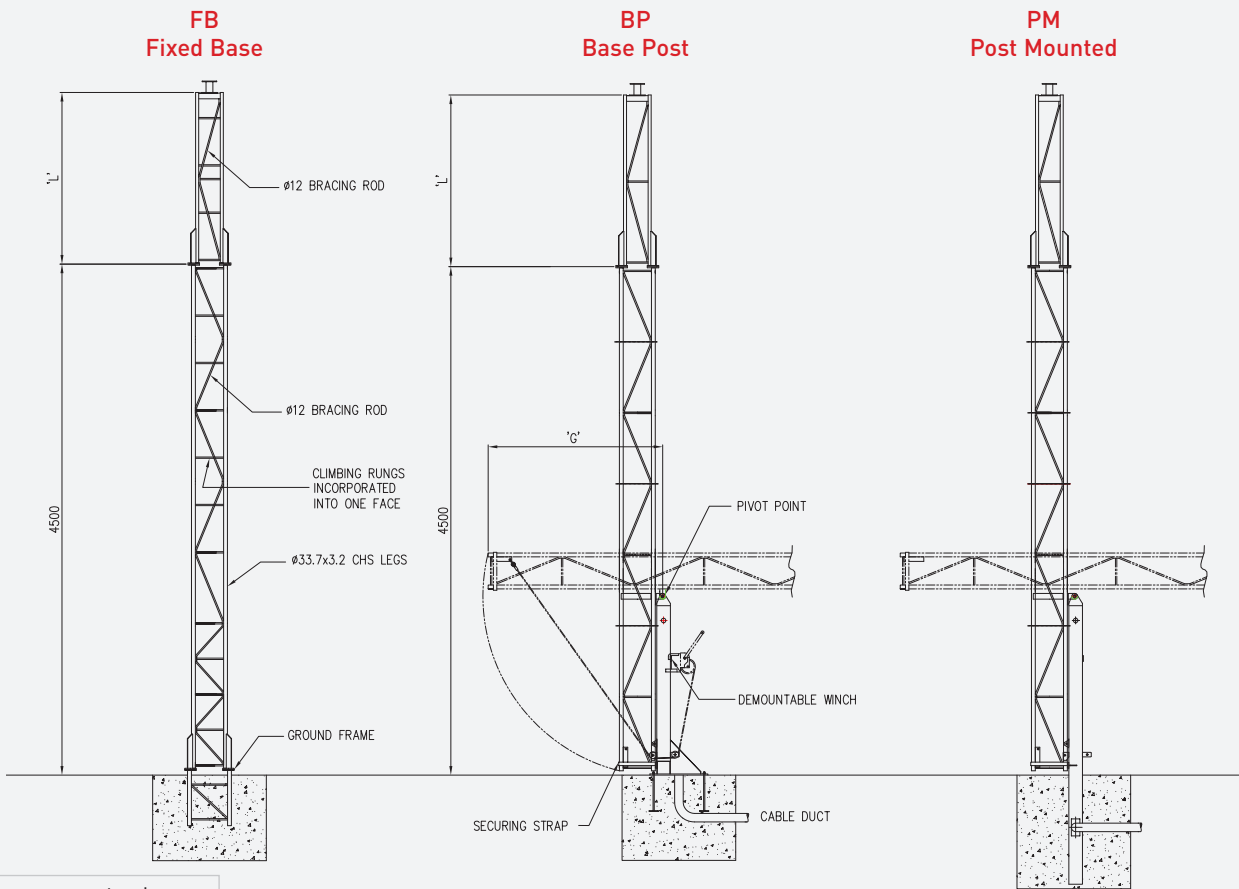

All camera mounting plates are DIA 127 with 8 No Ø 8.5 equi-spaced on 101.6 PCD. Ø 40 thro' column spacer

FOR BASE DETAILS REFER TO PAGE 18

Model No.	Height In metres	Tower type	Payload eqpt capacity *	Recom. max eqpt windload	Post size mm	Lower section face width	Mid section face width	Top section face width	Mid length metres L	Top length metres	Base plate size H	Holding down bolt centres I	Holding down bolt size	Tower rear clearance when tilting G	Winch
ACT1 Standard Duty	4.5	FB	50kgs	0.5m ²	-	316	-	-	-	-	-	-	-	-	N/A
		PM	50kgs	0.5m ²	120 x 120	316	-	-	-	-	-	-	-	1700	DW1000/AT
		BP	50kgs	0.5m ²	120 x 120	316	-	-	-	-	510 ²	450 ²	M20 x 300	1700	DW1000/AT
ACT2 Standard Duty	6	FB	50kgs	0.5m ²	-	316	-	244	-	1.5	-	-	-	-	N/A
		PM	50kgs	0.5m ²	120 x 120	316	-	244	-	1.5	-	-	-	1700	DW1000/AT
		BP	50kgs	0.5m ²	120 x 120	316	-	244	-	1.5	510 ²	450 ²	M20 x 300	1700	DW1000/AT
ACT3 Standard Duty	7.5	FB	35kgs	0.4m ²	-	316	-	244	-	3	-	-	-	-	N/A
		PM	35kgs	0.4m ²	120 x 120	316	-	244	-	3	-	-	-	1700	DW1500/AT
		BP	35kgs	0.4m ²	120 x 120	316	-	244	-	3	510 ²	450 ²	M20 x 300	1700	DW1500/AT
ACT3HD Heavy Duty	7.5	FB	50kgs	0.5m ²	-	386	-	316	-	3	-	-	-	-	N/A
		PM	50kgs	0.5m ²	150 x 150	386	-	316	-	3	-	-	-	2000	DW1500/ATHD
		BP	50kgs	0.5m ²	150 x 150	386	-	316	-	3	630 ²	550 ²	M24 x 300	2000	DW1500/ATHD
ACT4 Heavy Duty	9	FB	35kgs	0.25m ²	-	386	-	316	-	4.5	-	-	-	-	N/A
		PM	35kgs	0.25m ²	150 x 150	386	-	316	-	4.5	-	-	-	2000	DW1500/ATHD
		BP	35kgs	0.25m ²	150 x 150	386	-	316	-	4.5	630 ²	550 ²	M24 x 300	2000	DW1500/ATHD
ACT12	12	FB	30kgs	0.16m ²	-	386	316	244	4.5	3	-	-	-	-	N/A
		BP	30kgs	0.16m ²	180 x 180	386	316	244	4.5	3	630 ²	550 ²	M24 x 400	2200	DW2500/AT
		PM	30kgs	0.16m ²	180 x 180	386	316	244	4.5	3	-	-	-	2200	DW2500/AT
ACT14 Telescopic	14	BP	50kgs	0.5m ²	200 x 200	475	-	386	-	7	800 ²	700 ²	M27 x 600	2500	DW1500/AT14
		PM	50kgs	0.5m ²	200 x 200	475	-	386	-	-	-	-	-	2500	DW1500/AT14

*Where payloads are greater than those stated above, please contact Altron