

# → Wall Mounted Brackets

## Flat Wall Mounting Brackets

● Stock items

### ● WBI

Standard wall bracket

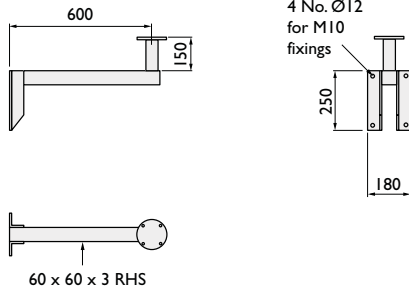

### ● WB2

Heavy duty wall bracket

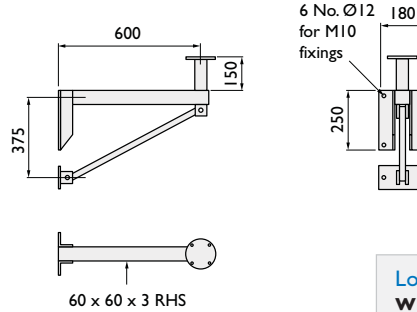

#### Load capacities

**WBI** Load capacity 25kgs

**WB2** Max load capacity 40kgs

### ● WB2-900

Extended wall bracket

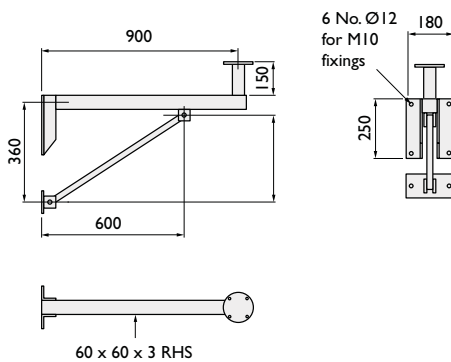

### ● WBI-F

Fixed camera wall bracket

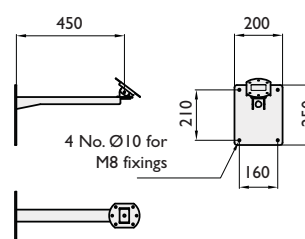

#### Load capacities

**WB2-900** Max load capacity 25kgs

**WBI-F** Load capacity **PTS-I** 10kgs

**HAS-I** 20kgs

### AW1705

Extended wall bracket

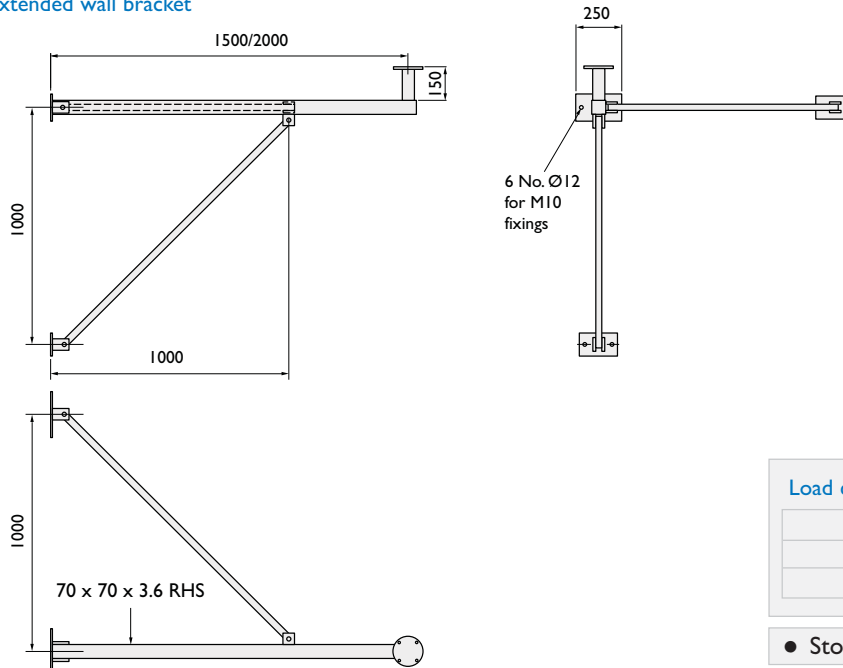

#### Load capacity 25kgs

Outreach	Part No.
1500 mm	● <b>AW1705/1.5</b>
2000 mm	<b>AW1705/2</b>

#### ● Stock items

- Other outreach sizes made to order
- Also available for dome mounting

All brackets for camera mounting have a Ø127 mounting plate with 8 no Ø8.5 equi - spaced on 101.6 PCD